

BRANDINA  
PARKLIEGE  
SUN LOUNGE

ORIGINAL  
**euroform** W<sup>®</sup>

MOD. 391

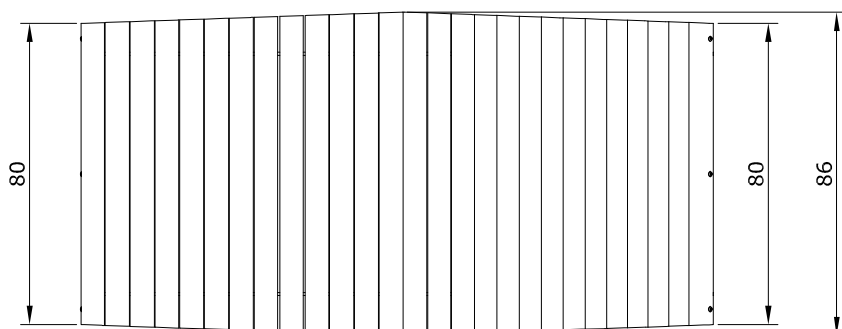
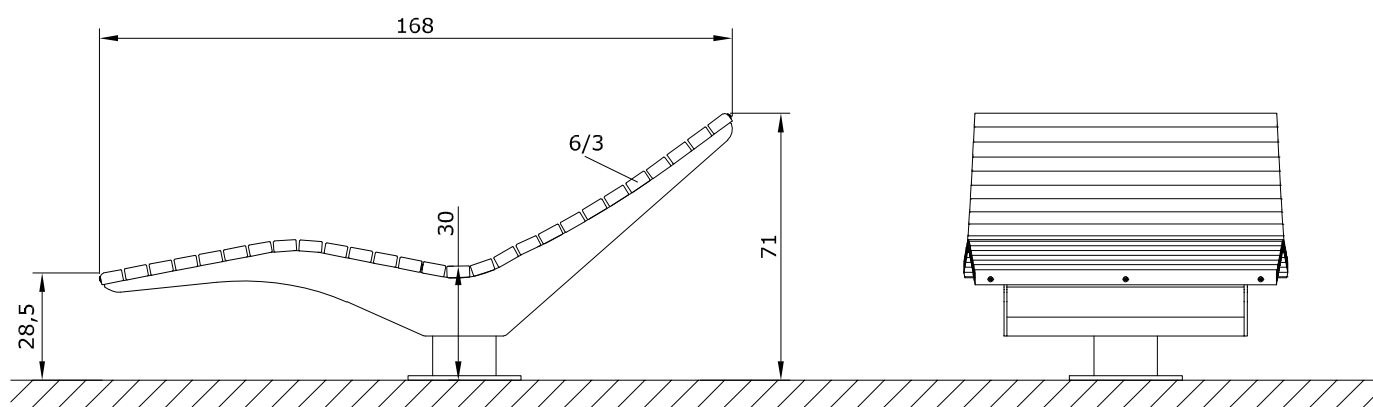

**Material frame:** steel sheet S235JR 8,0mm and tube S235JRH  $\varnothing$  168x6 mm

**Material seat:** 100% FSC certified Movingui, untreated.

**Surface treatment:** hot dip galvanization according to UNI EN ISO 1461. Powder coating 80 micron, fine texture. Tested to 500 h salt spray test according to DIN 50021 or ISO 9227-SS. UV resistance of the powder to as detailed in the Qualicoat guarantee table.

**Designer:** Arch. Thomas Winkler

Maßstab 1:20